

## Insulation Panel Fastener

**#14, #3 square drive, rico point**  
 For use in vented and/or composite nailboard applications

- Flat profile head for flush engagement to the nailboard.
- No plates necessary.
- 5/8" oversized head reduces fastener patterns.

## Application

### Insulation Panel Fasteners #14, #3 square drive, rico point

## Materials:

- Dimensional wood 2x (1-1/2" thick):  
 Min penetration: 1"
- Steel thickness (22 ga-20 ga-18 ga):  
 Min penetration: 3/4"

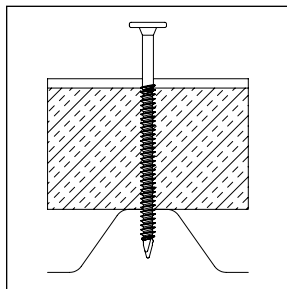

Head: #3 square drive  
 Head Dia: .645" – .620"  
 Head Height: .078" – .072"  
 Thread Major Dia: .245"  
 Shank Dia: .190"

**Strength (lbs ult.):**

Tensile: 1970  
 Shear: 2700  
 Torque: 125 in-lbs

**Pull-out (lbs avg.):**

1" Penetration (Face Grain): 823  
 1" Penetration (Edge Grain): 845  
 1-1/2" Penetration (Face Grain): 1344  
 1-1/2" Penetration (Edge Grain): 1320  
 Pull-out in grade E steel deck:  
 22 ga (.030): 498

## Notes

Dimensions are nominal inches unless noted. Ultimate values listed are the result of laboratory testing. Pull-out (pounds ultimate) strength values may vary from tabulated loads depending upon specific wood density variation. The specific job conditions should be considered and appropriate safety factors applied when specifying the proper fasteners.

## Selection

Length	Part No.	Carton Wt. (lbs)	Carton Qty.	Skid Qty.
2-5/8"	B7021-932P	29	500	12,000
2-3/4"	B7022-932P	30	500	12,000
3"	B7024-932P	32	500	12,000
3-1/2"	B7028-932P	36	500	12,000
4"	B7032-932P	40	500	12,000
4-1/2"	B7036-932P	44	500	12,000
5"	B7040-932P	48	500	12,000
5-1/2"	B7044-932P	52	500	12,000
6"	B7048-932P	56	500	12,000
6-1/2"	B7052-932P	60	500	12,000
7"	B7056-932P	64	500	12,000
7-1/2"	B7060-932P	68	500	12,000
8"	B7064-932P	36	250	6,000
9"	B7068-932P	41	250	6,000
10"	B7072-932P	45	250	6,000
11"	B7076-932P	49	250	6,000
12"	B7080-932P	53	250	6,000

## Installation

Install fasteners with self-drill fastener installation tool or drill using caution to avoid fastener strip out. The standard carton package includes one #3 square drive bit (Part Number J0945P).

## Options

## Coatings

