

#12 Belted

#12 Dekfast insulation attachment

For insulation attachment using #12 Dekfast with a #3 Phillips drive collated for the isofast™ fastening system

- “The fastest way to install roofing fasteners!”
- Belted fasteners and plates increase productivity and are ergonomically correct, allowing the contractor to install the roof assembly in an upright position when using the IF-160 installation tool.

Application

#12 Belted Fasteners
Collated fasteners for insulation and membrane attachment

Materials:

- Steel thickness from 22 ga (.028 in.) through 18 ga (.045 in.):
Min penetration: 3/4"
- Wood 2x: (1-1/2" thick):
Min penetration 1"

Use with:

- IFC/PH 70x70 (2-3/4" x 2-3/4")
Galvalume stress plates
- IF/IG-C 82x40 (3-1/4" x 1-1/2")
Galvalume stress plates

Steel roof decks include all FM approved 18-20-22 ga

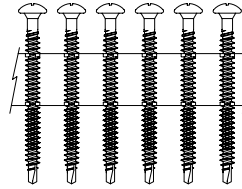
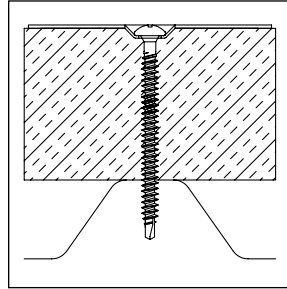

Head Drive: #3 Phillips
Head Height: Max .118"
Head Dia: Max .448"
Thread Major Dia: .222"
Shank Dia: .167"

Strength (lbs ult.):

Tensile: 2410
Torsional: 76 in-lbs min
Shear: 1815

Pull-out (lbs avg.):

Steel:
22 ga: 513
20 ga: 695
18 ga: 787
2x dim. lumber (1" penetration): 462
Plywood 3/4" thick (through penetration): 575

Notes

Dimensions are nominal inches unless noted. Ultimate values listed are the result of laboratory testing. Pull-out (pounds ultimate) strength values may vary from tabulated loads depending upon the uniqueness of the application. The specific job conditions should be considered and appropriate safety factors applied when specifying the proper fasteners.

Selection

| Length | Part No. | Carton Wt. (lbs) | Carton Qty. | Skid Qty. |
|--------|--------------|------------------|-------------|-----------|
| 2-1/4" | A8518-995TGL | 13 | 750 | 54,000 |
| 2-7/8" | A8523-995TGL | 15 | 750 | 54,000 |
| 3-1/4" | A8526-995TGL | 17 | 750 | 54,000 |
| 3-3/4" | A8530-995TGL | 20 | 750 | 54,000 |
| 4-1/2" | A8536-995TGL | 23 | 750 | 36,000 |
| 5" | A8540-995TGL | 25 | 750 | 36,000 |
| 6" | A8545-995TGL | 30 | 750 | 36,000 |
| 7" | A8556-995TGL | 36 | 750 | 36,000 |

Approvals

Dekfast fasteners and plates are Factory Mutual approved for attachment of insulation board and/or roof cover to roof deck. Refer to FM Approval Guide and Supplements for current FM approved insulation fastening patterns. #12 belted fasteners exceed Factory Mutual corrosion-resistance Standard 4470.

Installation

#12 belted fasteners must be installed with the IF 160 automatic setting tool.

Options

