

ZAC® Impax™  
3/8" HWH Alloy Capped

ZAC® self-drill 3/8" HWH  
Zinc aluminum capped drill screws  
For metal to metal and insulated panel to metal

- ZAC: the most widely used zinc aluminum capped fastener in the industry.
- Precision cold forged assuring superior point strength and the fastest drilling time performance through high strength steel and nested purlins.
- Designed and engineered to have low driving and thread engagement torque to prevent damage to the cap during installation while providing maximum clamp load.
- Integral cupped Hex Washer Head can never red rust.

Application

12-24 ZAC (3/8")  
4.5 point and 5 point  
Metal to metal

Impax 4.5  
Drilling capacity: .075 – .375  
Impax 5  
Drilling capacity: .075 – .500  
Thickness is based on single thickness purlin/girt or multiple material thickness combined for total.  
Thread length:  
ZAC 4.5: 12-24 x 1-1/4": .650  
ZAC 5: 12-24 x 1-1/4": .520  
12-24 x 1-1/2": .770  
12-24 x 2": 1.020

Min projection: 3/16" of threads below substrate

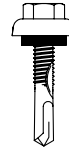
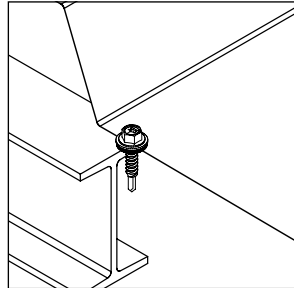

3/8" AF Zinc Aluminum Capped Hex Washer Head  
Thread Major Dia: .216 – .210  
Thread Minor Dia: .186 – .181  
**Strength (lbs ult.):**  
Tensile: 3450  
Torsional: 100 in-lbs  
Shear: 2420  
**Pull-out (lbs ult.):**  
12 ga (.105): 1378  
3/16" (.187): Exceeds tensile value  
1/4" (.250): Exceeds tensile value  
**Pull-over with assembled Seal washer (lbs ult.):**  
22 ga (.030): 1647  
24 ga (.024): 1310  
26 ga (.018): 794

12-14 Insulated  
Panel Fastener  
Designed for attaching  
insulated foam panels to steel.

Drilling capacity: .035 – .210  
Thickness is based on normal, single thickness purlin/girt or multiple material thickness combined for total.  
Min projection: 3/16" of threads below substrate

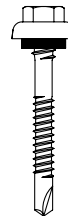
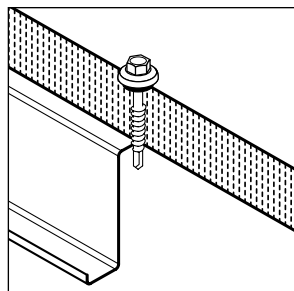

3/8" AF Zinc Aluminum Capped  
Thread Major Dia: .215 – .209  
Thread Minor Dia: .164 – .157  
**Strength (lbs ult.):**  
Tensile: 2900  
Torsional: 92 in-lbs  
Shear: 2050  
**Pull-out (lbs ult.):**  
12 ga (.105): 1539  
14 ga (.075): 1010  
16 ga (.060): 724

**Notes** Dimensions are nominal inches unless noted. Self-drill pull-out values (pounds ultimate) are based on 57,000 psi hot rolled steel material. Lap self-drill pull-out values are based on 40,000 psi AZ55 Galvalume steel sheet material. Ultimate values listed are the result of laboratory testing. The specific job conditions should be considered and appropriate safety factors applied when specifying the proper fasteners #12 fasteners 1" and longer have special long pilot lengths to accommodate nested purlins.

Selection

Length	Part No. 12-14 Insulated	Part No. 12-24 (4.5) and 12-24 (5)	Panel Thickness
12-24 x 1-1/4" (4.5)	—	S4665-FLF	—
12-24 x 1-1/4" (5)	—	S4669-FLF	—
12-24 x 1-1/2" (5)	—	S4742-FLF	—
12-14 x 1-7/8"	S7045-FMF	—	3/4" to 1"
12-14 x 2-3/8"	S7065-FMF	—	1-1/8" to 1-1/2"
12-14 x 3-1/4"	S7085-FMF	—	1-5/8" to 2-3/8"

Installation

Tools: 0 – 2000 rpm screwdriver equipped with depth sensing nosepiece.

Options

VistaCoat™



Painted

